

# A66 Northern Trans-Pennine Project

Scheme 07: Bowes Bypass

TR010062

**General Scheme Outline Plans**

**(Rev 2)**

Response to ExA's Procedural Decision PD-006 in Rule 6 Letter

Deadline 7

09 May 2023



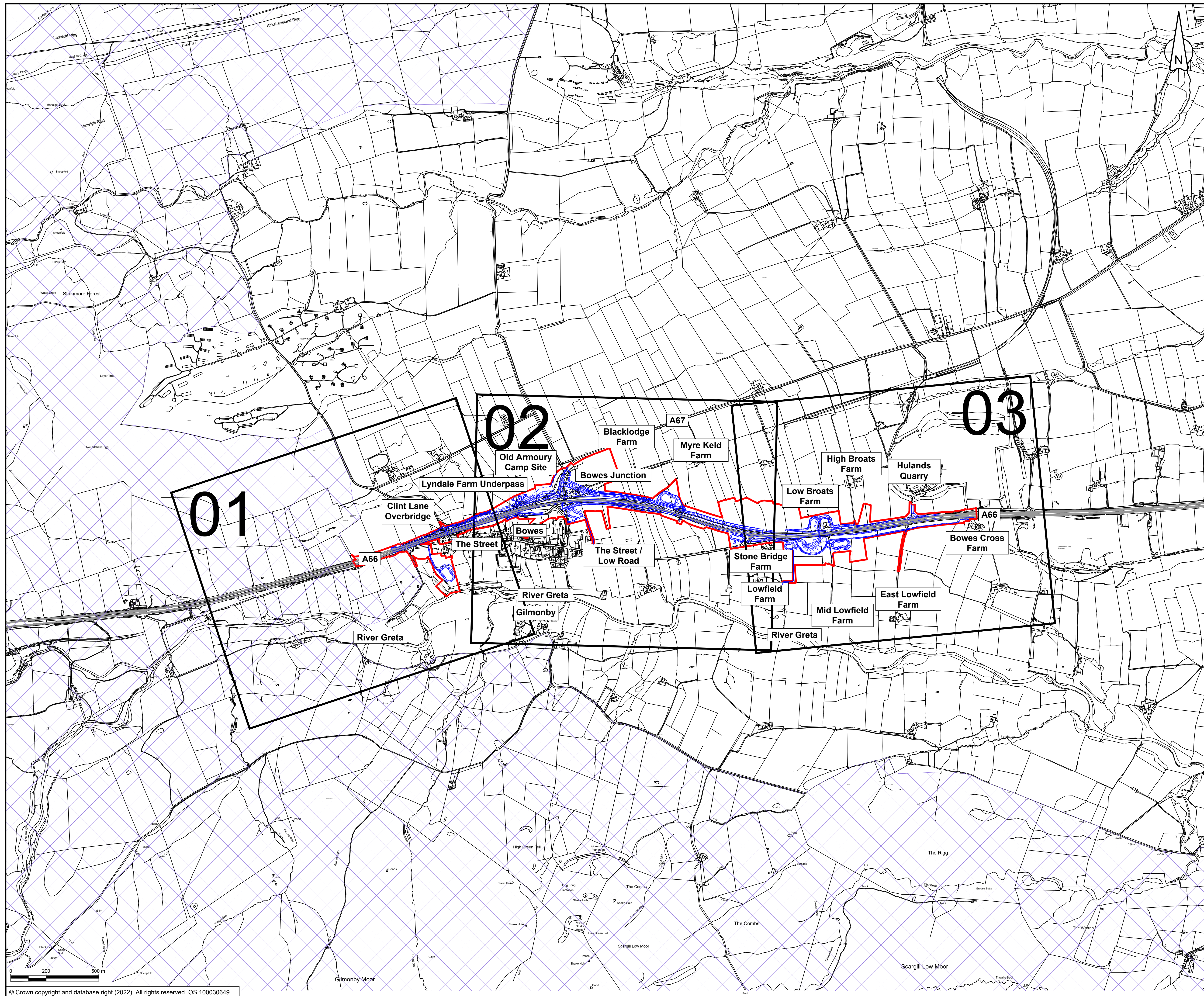



**NOTES**

1. ALL DIMENSIONS ARE IN METRES UNLESS NOTED OTHERWISE.

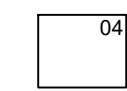
**KEY**

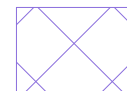
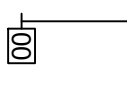
-  THE SCHEME (SHOWN FOR ILLUSTRATIVE PURPOSES ONLY)
-  SHEET USED AS PART OF THIS DRAWING SERIES
-  SHEET NOT USED AS PART OF THIS DRAWING SERIES
-  AREA OF OUTSTANDING NATURAL BEAUTY (AONB)
-  CHAINAGE (MEASURED DISTANCE ALONG THE SCHEME LENGTH)

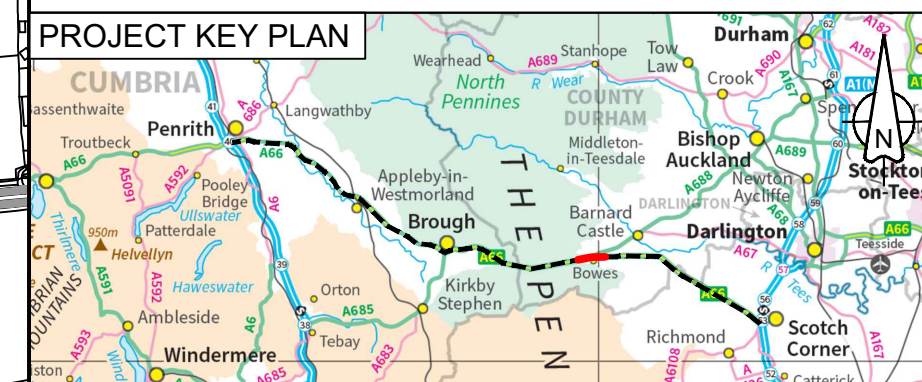

C02	Change Application - revised PMA design at Low Broats				
	RDWA	TEGG	THAL	THAL	FMOL
	21/04/23	21/04/23	03/05/23	03/05/23	03/05/23

Revision details					
Created	Checked	Reviewed	Approved	Authorised	
dd/mm/yy	dd/mm/yy	dd/mm/yy	dd/mm/yy	dd/mm/yy	dd/mm/yy

Purpose  
Response to ExA's Procedural Decision PD-006 in Rule 6 Letter

PINS Reference Number  
TR010062

Client  
3 Piccadilly Place  
Manchester  
M1 3BN



Project Name / Scheme Name  
**A66 Northern Trans-Pennine Project  
Scheme 07  
Bowes Bypass**

Drawing Title  
**General Scheme Outline Plans  
Submitted in response to PD-006  
Key Plan**

Project Ref. No.	Stage	Scale :	@ A1
---	PCF4	1:10000	
		Dimensions :	M

Drawing Number	Project	Originator	Volume
HE565627 - AMY - HAC -			
S07	-DR-CH-	500004	
Location	Type	Role	Number

Suitability	Suitability Description	Revision
A	Approved for Stage Complete	C02



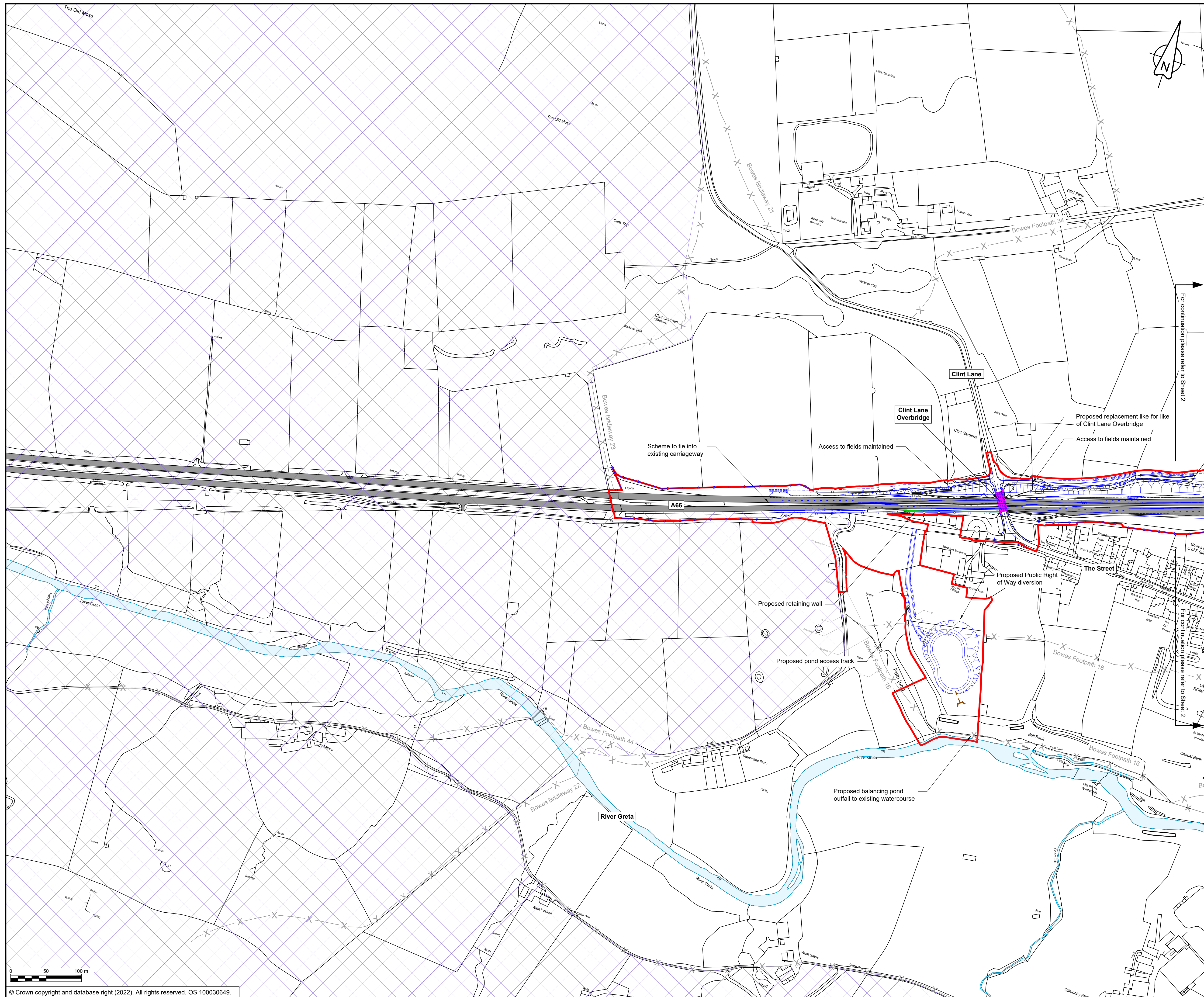

- NOTES**
1. ALL DIMENSIONS ARE IN METRES UNLESS NOTED OTHERWISE.
  2. FOR ENVIRONMENTAL DETAILS REFER TO THE ENVIRONMENTAL MASTERPLAN AND ASSOCIATED DRAWINGS/DOCUMENTS.
  3. THE DESIGN OF THE SCHEME IS SHOWN HERE FOR ILLUSTRATIVE PURPOSES ONLY AND WILL BE SUBJECT TO DETAILED DESIGN DEVELOPMENT IN ACCORDANCE WITH THE PROVISIONS OF THE DEVELOPMENT CONSENT ORDER.
  4. THESE PLANS SHOULD BE READ IN CONJUNCTION WITH RIGHTS OF WAY AND ACCESS PLANS.

- KEY**
- ORDER LIMITS
  - AREA EXCLUDED FROM ORDER LIMITS
  - AREA OF OUTSTANDING NATURAL BEAUTY (AONB)
  - EXISTING WATERCOURSE
  - EXISTING A66 CARRIAGEWAY
  - PARISH BOUNDARY
  - EXISTING PUBLIC RIGHT OF WAY
  - PROPOSED WORKS
  - PROPOSED EARTHWORKS
  - PROPOSED CULVERT & HEADWALL
  - PROPOSED RETAINING STRUCTURE
  - PROPOSED BRIDGE / VIADUCT
  - PROPOSED UNDERPASS / TUNNEL

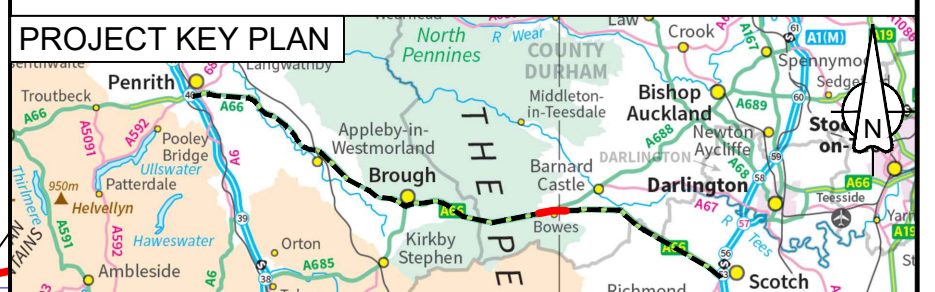

C01	Submitted in response to PD-006				
	SMOR	TEGG	THAL	THAL	FMOL
	14/11/22	15/11/22	15/11/22	15/11/22	15/11/22
Revision	Revision details				
	Created	Checked	Reviewed	Approved	Authorised
	dd/mm/yy	dd/mm/yy	dd/mm/yy	dd/mm/yy	dd/mm/yy

Purpose  
Response to ExA's Procedural Decision PD-006 in Rule 6 Letter

PINS Reference Number  
TR010062

Client  
3 Piccadilly Place  
Manchester  
M1 3BN



Project Name / Scheme Name  
**A66 Northern Trans-Pennine Project  
Scheme 07  
Boves Bypass**

Drawing Title  
**General Scheme Outline Plans  
Submitted in response to PD-006  
Sheet 1 of 3**

Project Ref. No.	Stage	Scale	@ A1
---	PCF4	1:2500	
		Dimensions	M

Drawing Number	Project	Originator	Volume
HE565627	- AMY	- HAC	-
S07	-DR-CH-	500005	
Location	Type	Role	Number

Suitability	Suitability Description	Revision
A	Approved for Stage Complete	C01



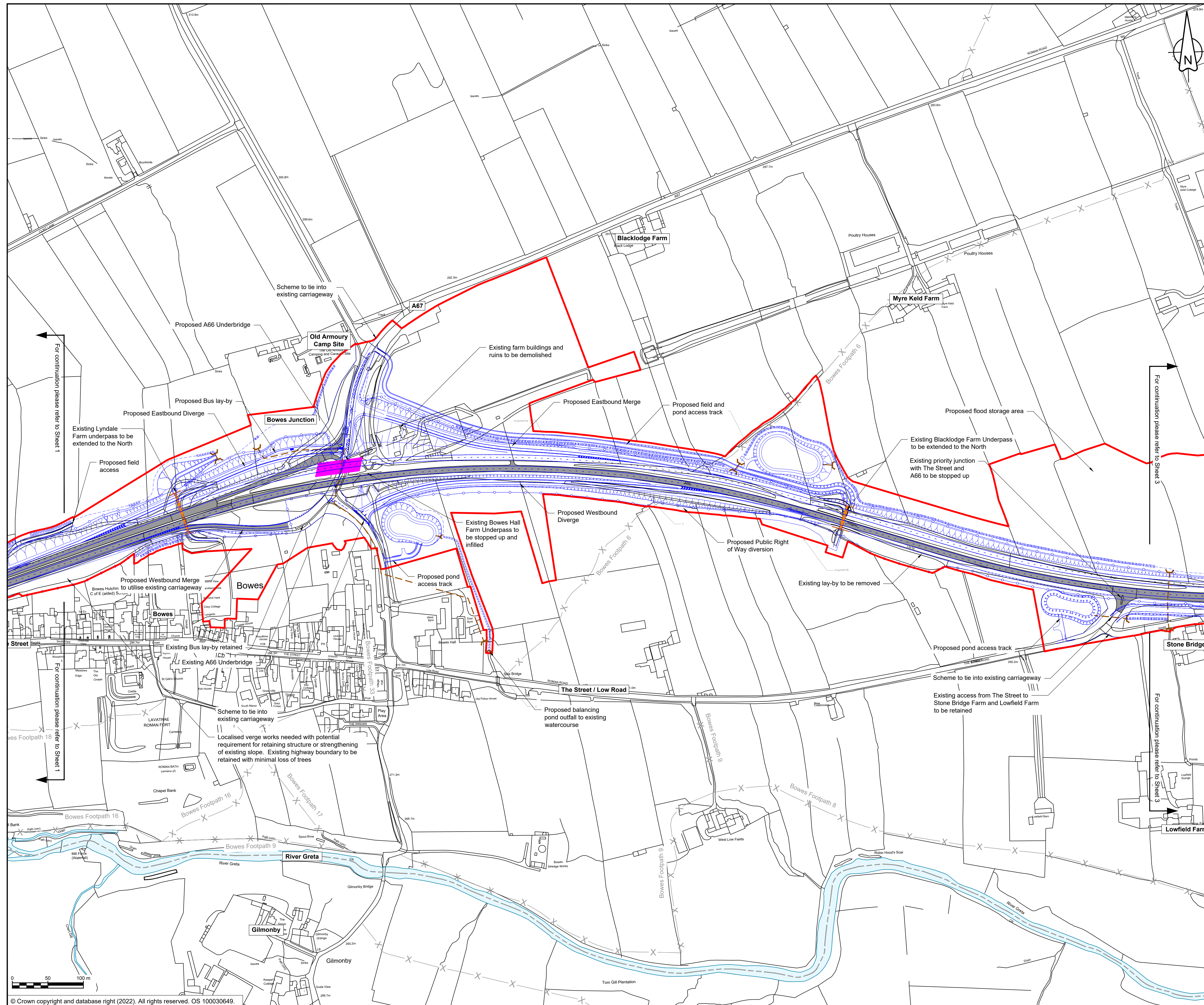

- NOTES**
1. ALL DIMENSIONS ARE IN METRES UNLESS NOTED OTHERWISE.
  2. FOR ENVIRONMENTAL DETAILS REFER TO THE ENVIRONMENTAL MASTERPLAN AND ASSOCIATED DRAWINGS/DOCUMENTS.
  3. THE DESIGN OF THE SCHEME IS SHOWN HERE FOR ILLUSTRATIVE PURPOSES ONLY AND WILL BE SUBJECT TO DETAILED DESIGN DEVELOPMENT IN ACCORDANCE WITH THE PROVISIONS OF THE DEVELOPMENT CONSENT ORDER.
  4. THESE PLANS SHOULD BE READ IN CONJUNCTION WITH RIGHTS OF WAY AND ACCESS PLANS.

- KEY**
- ORDER LIMITS
  - AREA EXCLUDED FROM ORDER LIMITS
  - AREA OF OUTSTANDING NATURAL BEAUTY (AONB)
  - EXISTING WATERCOURSE
  - EXISTING A66 CARRIAGEWAY
  - PARISH BOUNDARY
  - EXISTING PUBLIC RIGHT OF WAY
  - PROPOSED WORKS
  - PROPOSED EARTHWORKS
  - PROPOSED CULVERT & HEADWALL
  - PROPOSED RETAINING STRUCTURE
  - PROPOSED BRIDGE / VIADUCT
  - PROPOSED UNDERPASS / TUNNEL

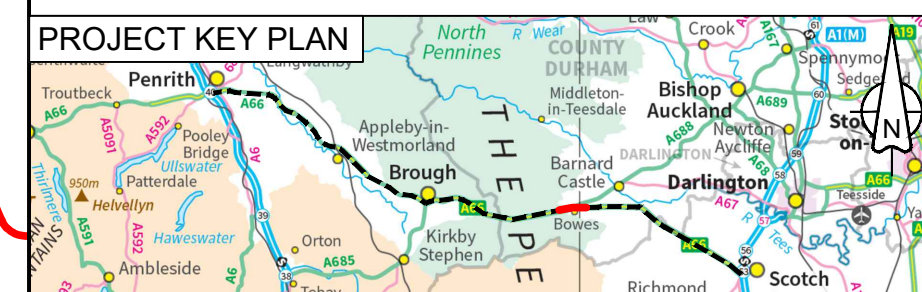

C01	Submitted in response to PD-006				
	SMOR	TEGG	THAL	THAL	FMOL
	14/11/22	15/11/22	15/11/22	15/11/22	15/11/22
Revision details					
Revision	Created	Checked	Reviewed	Approved	Authorised
	dd/mm/yy	dd/mm/yy	dd/mm/yy	dd/mm/yy	dd/mm/yy

Purpose  
Response to ExA's Procedural Decision PD-006 in Rule 6 Letter

PINS Reference Number  
TR010062

Client  
3 Piccadilly Place  
Manchester  
M1 3BN

Project Name / Scheme Name  
**A66 Northern Trans-Pennine Project  
Scheme 07  
Bowes Bypass**

Drawing Title  
**General Scheme Outline Plans  
Submitted in response to PD-006  
Sheet 2 of 3**

Project Ref. No.	Stage	Scale :	@ A1
---	PCF4	1:2500	
		Dimensions :	M

Drawing Number	Project	Originator	Volume
HE565627	- AMY	- HAC	-
S07	- DR	- CH	- 500006
Location	Type	Role	Number

Suitability	Suitability Description	Revision
A	Approved for Stage Complete	C01



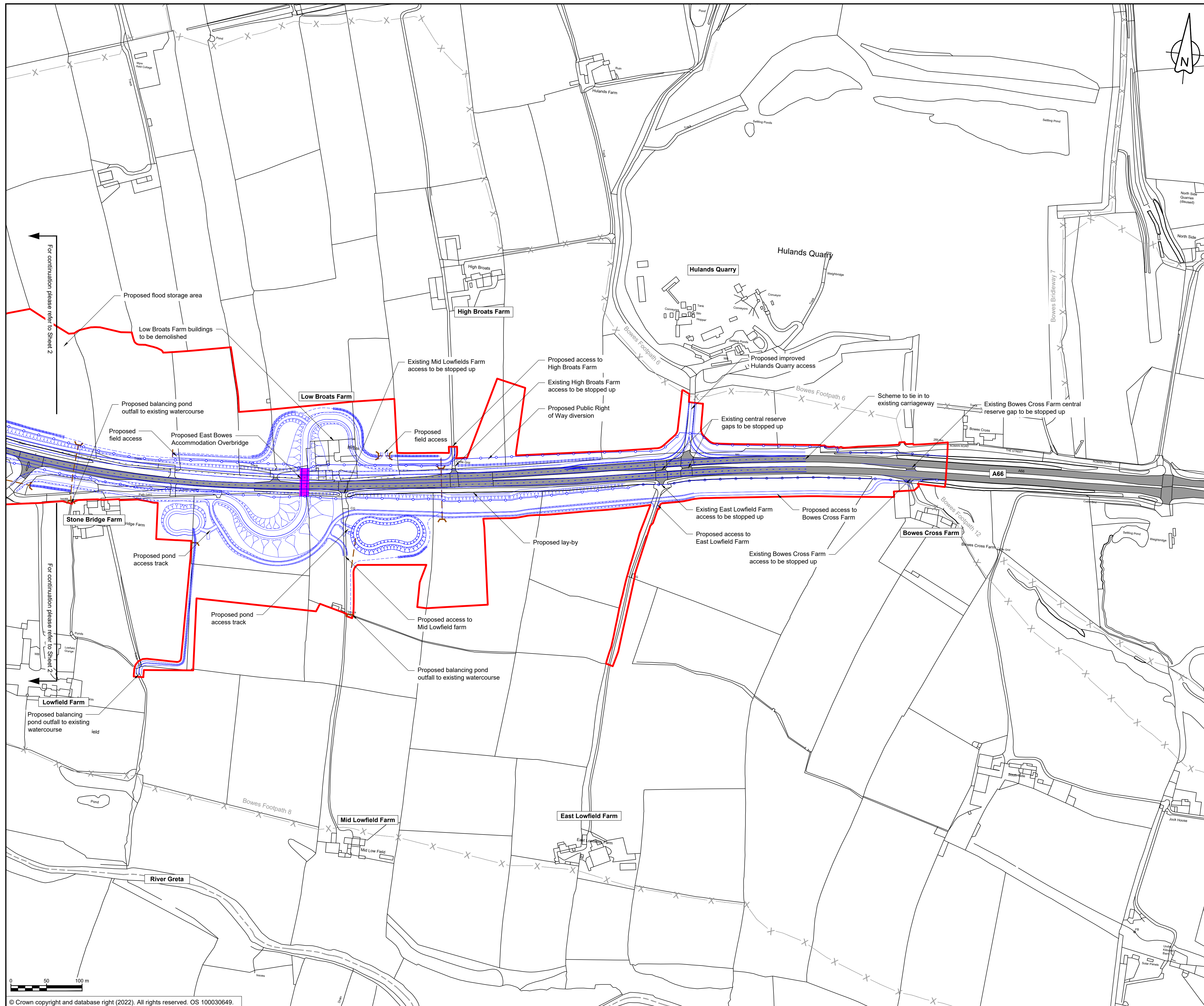

- NOTES**
1. ALL DIMENSIONS ARE IN METRES UNLESS NOTED OTHERWISE.
  2. FOR ENVIRONMENTAL DETAILS REFER TO THE ENVIRONMENTAL MASTERPLAN AND ASSOCIATED DRAWINGS/DOCUMENTS.
  3. THE DESIGN OF THE SCHEME IS SHOWN HERE FOR ILLUSTRATIVE PURPOSES ONLY AND WILL BE SUBJECT TO DETAILED DESIGN DEVELOPMENT IN ACCORDANCE WITH THE PROVISIONS OF THE DEVELOPMENT CONSENT ORDER.
  4. THESE PLANS SHOULD BE READ IN CONJUNCTION WITH RIGHTS OF WAY AND ACCESS PLANS.

- KEY**
- ORDER LIMITS
  - AREA EXCLUDED FROM ORDER LIMITS
  - AREA OF OUTSTANDING NATURAL BEAUTY (AONB)
  - EXISTING WATERCOURSE
  - EXISTING A66 CARRIAGEWAY
  - PARISH BOUNDARY
  - EXISTING PUBLIC RIGHT OF WAY
  - PROPOSED WORKS
  - PROPOSED EARTHWORKS
  - PROPOSED CULVERT & HEADWALL
  - PROPOSED RETAINING STRUCTURE
  - PROPOSED BRIDGE / VIADUCT
  - PROPOSED UNDERPASS / TUNNEL

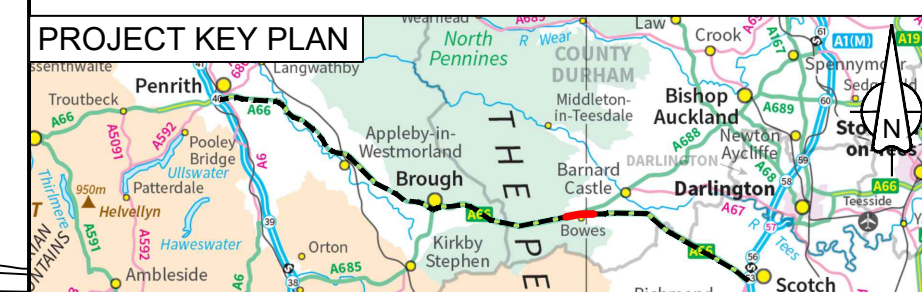

C02	Change Application - revised PMA design at Low Broats				
	RDAW	TEGG	THAL	THAL	FMOL
	03/05/23	03/05/23	03/05/23	03/05/23	03/05/23
Revision details					
Revision	Created	Checked	Reviewed	Approved	Authorised
	dd/mm/yy	dd/mm/yy	dd/mm/yy	dd/mm/yy	dd/mm/yy

**Purpose**  
Response to ExA's Procedural Decision PD-006 in Rule 6 Letter

**PINS Reference Number**  
TR010062

**Client**  
3 Piccadilly Place  
Manchester  
M1 3BN

**Project Name / Scheme Name**  
A66 Northern Trans-Pennine Project  
Scheme 07  
Bowes Bypass

**Drawing Title**  
General Scheme Outline Plans  
Submitted in response to PD-006  
Sheet 3 of 3

Project Ref. No.	Stage	Scale : 1:2500	@ A1
---	PCF4	Dimensions : M	

Drawing Number	Project	Originator	Volume
HE565627	- AMY	- HAC	-
S07	-DR-CH-	500007	
Location	Type	Role	Number

Suitability	Suitability Description	Revision
A	Approved for Stage Complete	C02